

**For Lease: Office / Warehouse / Distribution**

# **BROOKSIDE INDUSTRIAL PARK**



For more information, please contact:

**Larry W. Harshman, CPM®**

317-345-8981 (cell)

317-630-1000 (office)

harshman@harshmanonline.com



**HARSHMAN  
PROPERTY  
SERVICES, LLC  
317-630-1000**

- Located at 16<sup>th</sup> Street and Sherman Drive, Indianapolis
- 10 single-story buildings totaling 303,766 square feet on 33.95 acres
- Available space from 1,800 to 27,657 square feet
- Zoned 1-3-U (Medium Industrial, Urban District), an intermediate district located away from residential areas and buffered by lighter industrial districts
- Close to I-70 and downtown
- Heavy power available
- Dock and drive-in access available

**For Lease: Office / Warehouse / Distribution**

# **BROOKSIDE INDUSTRIAL PARK**

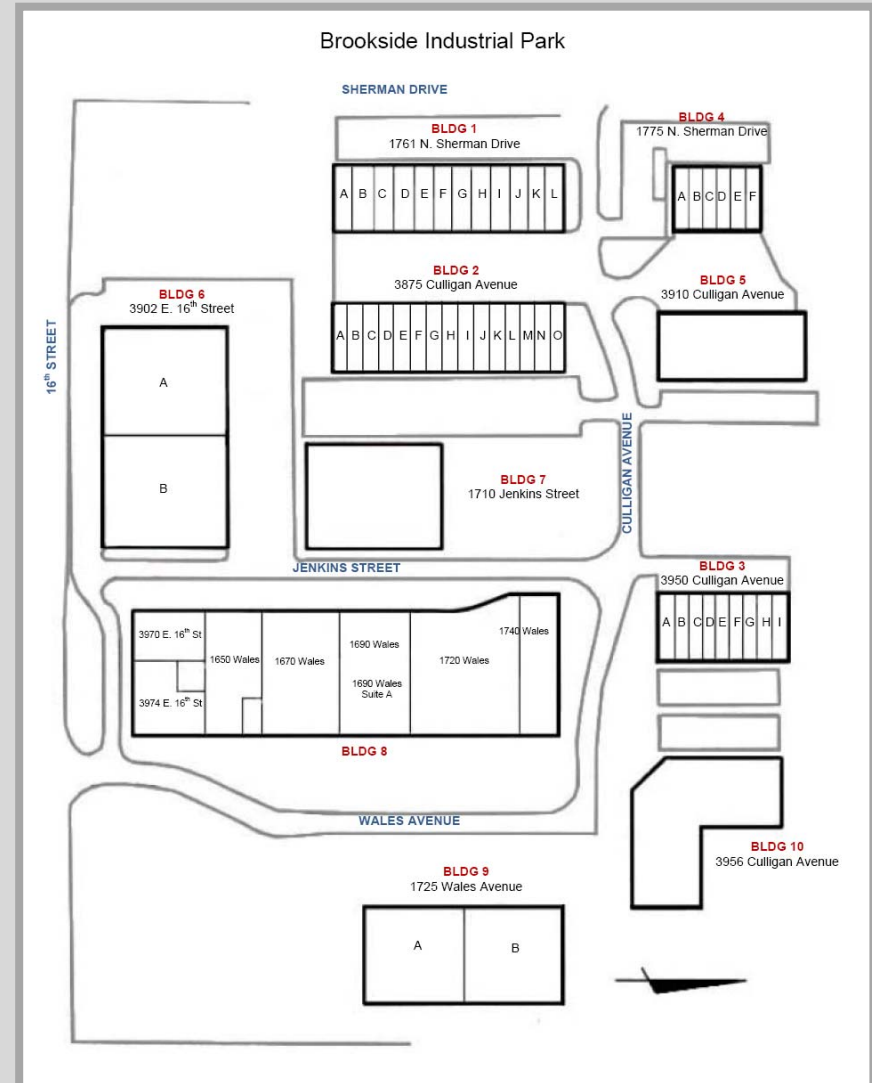

**HARSHMAN  
PROPERTY  
SERVICES, LLC  
317-630-1000**